

# User and Maintenance Manual



Scan QR code and visit the website to see more details about our products



Emme Antincendio S.r.l.  
www.emme-italia.com

Via del Molino, 40 - 52010 Corsalone (AR) - Italy - info@emme-italia.com - Tel. +39.0575.511320  
Other branches Emme Antincendio s.r.l. in Italy : Milano - Padova - Roma - P.IVA/ C.F. 11208251006 - R.E.A. FI-632545

## 23020-7 : 2 Kg Portable CO2 Fire Extinguisher



OPTIONAL



- **CYLINDER**  
Alloy steel, epoxy polyestere powder painting, Red Ral 3000.
- **EXTINGUISHING AGENT**  
Carbon Dioxide 99,99%
- **VALVE**  
CPF M. 25x2, brass body, levers with red painting Ral 3000.
- **USE**  
B fire rating (flammable liquids).

Note: image is for illustrative purpose only, the product purchased can have some differences

2 Kg CO2 fire extinguisher, temperature range from -30°C to +60°C, manufactured in accordance to UNI EN 3-7 (D.M. 7.1.2005), approved Marine Equipment Directive MED 2014/90/EU, certified according to the directive for pressure equipment PED 2014/68/EU.

Quality Product certification guaranteed by Bureau Veritas Italia.

Suitable for use on fire involving electrical voltages up to 1.000 V, at a distance of 1 mt

APPROVED\CERTIFIED FIRE EXTINGUISHER:



**FIRE RATING :**



34

© REPRODUCTION IS PROHIBITED

File name	Type of document	Fire Extinguisher Model	Date	Rele.	Check	Rev.	Pag.
23020-7_User Manual	Use and Maintenance user manual	23020-7	13/01/2021	M.R		1	1 of 2

# 23020-7 : 2 Kg CO2 Fire Extinguisher

## TECHNICAL SPECIFICATIONS

FIRE RATING	34 B
EXTINGUISHING AGENT	Carbon Dioxide 99,99 % (CO <sub>2</sub> )
TEMPERATURE RANGE	-30°C / +60°C
NOMINAL CHARGE	2 Kg
FULL WEIGHT	~ 7,2 Kg
DIMENSIONS	Height (base - valve) 570 +/- 10 mm Diameter (cylinder) 104 +/- 2 mm
DISCHARGE TIME	~ 7,7 seconds

## MODALITY OF USE

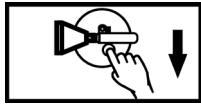

1) REMOVE SAFETY PIN



2) SQUEEZE GRIP LEVER

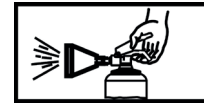

3) AIM THE JET AT BASE OF FIRE

Follow the instructions present on the marking label.

**ATTENTION:** Do not direct the jet at people. If you're dispensing in close spaces, then ventilate the room. The fire extinguisher can be used on fire involving electrical voltages up to 1'000 V, at a distance of 1 meter.

## INSTALLATION AND COMMISSIONING

The installation of the extinguisher must be performed according to the rules in force.

The extinguisher have to be installed in a safe and stable support, with a gripping at a maximum height of 110 cm. The fire extinguisher must be free of obstructions and marked by an appropriate identifying label.

It is recommended to install it in a dry place, protected from the atmospheric agents.

It is recommended the installation of water-based extinguishers for close spaces.

The commissioning of the fire extinguisher for the protection of the area must be carried out by qualified personnel according to the rule in force within 6 months from the date of production and/or placing on the market, reported in the declaration of conformity released by the producer.

## MAINTENANCE PERIODS FOR EFFICIENCY GUARANTEES

The maintaining of the product efficiency have to be carried out from the responsible person.

It is recommended a visual check of the efficiency state every three months since the commissioning time apart if there are different dispositions.

It is advisable to : verify that the extinguisher would be in a well-balanced, safety and impediment-freed position ; identify the extinguisher with an appropriate identification sign; make sure of its structural integrity and that is free from any damage; check that the original documentations is available.

Any restoration operations and instrumental checking have to be realized exclusively by qualified personnel who possess the necessary documentations to maintain the constancy of the product performance.

Any tampering or intromission by unauthorized personnel voids the product warranty.

File name	Type of document	Fire Extinguisher Model	Date	Rele.	Check	Rev.	Pag.
23020-7_User manual	Use and Maintenance user manual	23020-7	13/01/2021	M.R		1	2 of 2